

DESIGN STATEMENT

ENTRANCE STELE

A stone stele marks the entrance to the park. The stele is engraved with the park's name, names of municipal officials and park supporters, and dedication date.

ENGRAVED PATH

Leading from the stele and into the park is an engraved stone pathway. The words create a sense of forward-motion, drawing the visitor along the path and into the park as the words are read, engaging the visitor in a metaphorical journey symbolic of the idea of community service as a "path" or "journey."

MEMORIAL STELE

The engraved path continues into the heart of the park, ending at a large stone bench situated at the apex of a triangle formed by the bench/open seating area/play area. The bench's location is reflective of community service—that is, being in the thick of things—yet it is somewhat set apart, among verdant plantings and a bubbling fountain which provide some sense of separation, and peace and quiet, for personal reflection.

The memorial stele is engraved with Ms. Maffin's image and a synopsis of her contributions to the community and city through her years of dedicated service in both professional and private life. Engraved, also, are comments on community service. There is ample space for future engravings, for example, of the names of other community members who have made significant contributions in community service.

(Note that the text of the engravings as shown are for illustrative purposes only.)

S.A.F.

ENTRANCE STELE, SECTION, SCALE 1:1



SEAT WALL AND MEMORIAL STELE, ELEVATION, SCALE 1:1

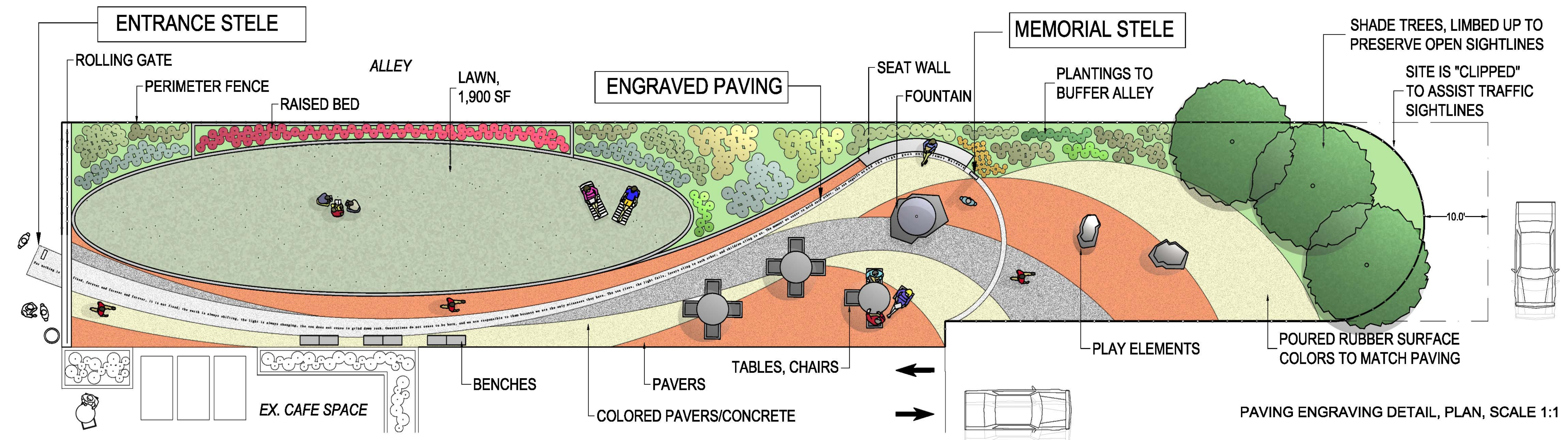
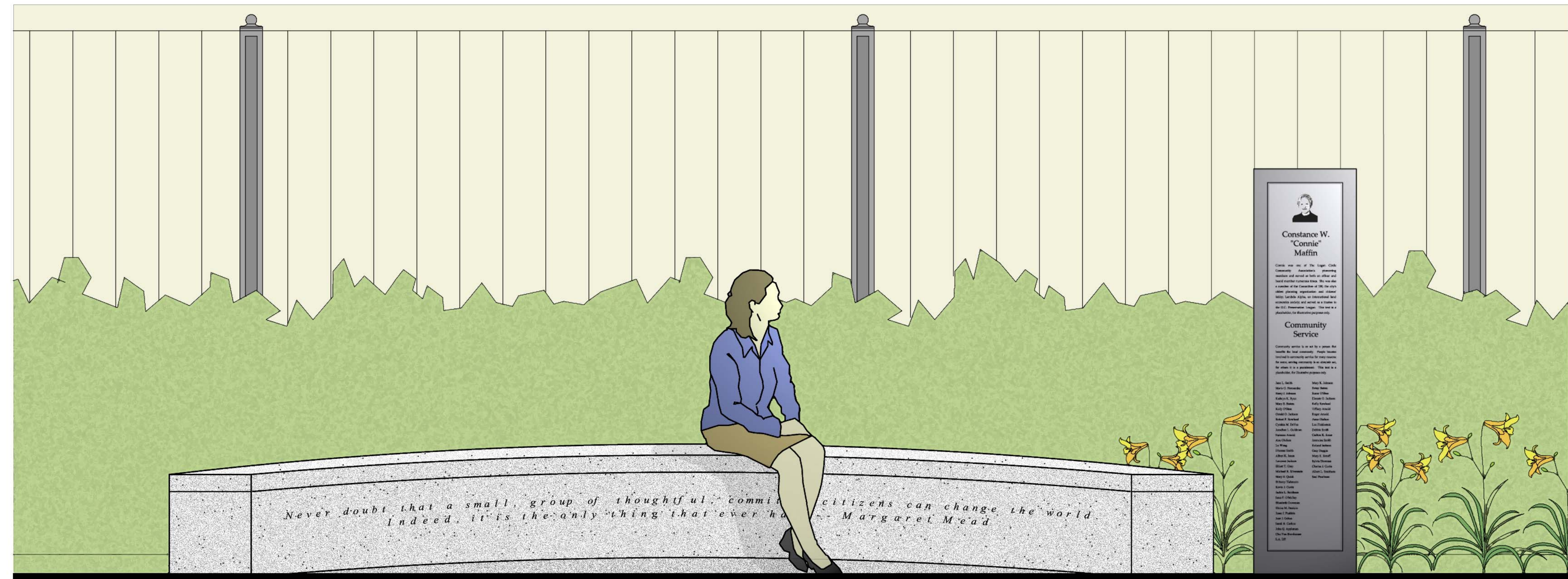

How wonderful is it that nobody need wait a single moment before starting to improve the world. -- Anne Frank

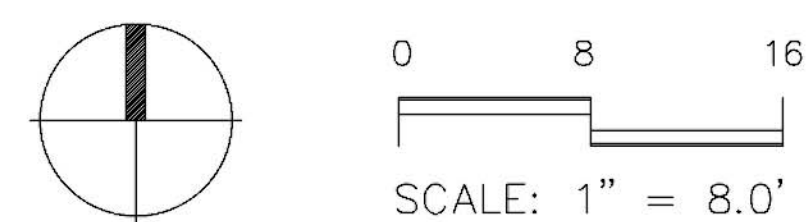

DRAFT

10TH STREET PARK, NW, WASHINGTON, D.C.
MEMORIAL TO CONSTANCE MAFFIN AND COMMUNITY SERVICE

ILLUSTRATIVE DRAWING

DC PARKS & RECREATION
 OFFICE OF PLANNING & CAPITAL PROJECTS
 SHERRY FREAR, ASLA

JULY 15, 2009