

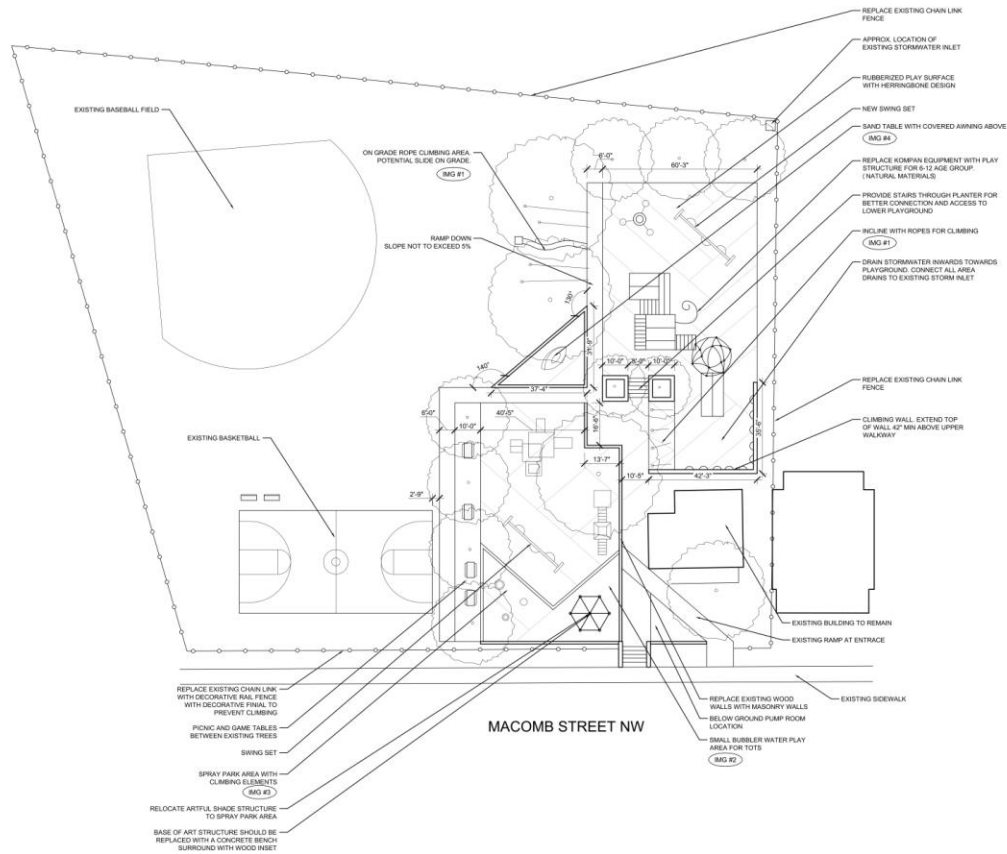

GOVERNMENT OF THE DISTRICT OF COLUMBIA
Department of Parks and Recreation



(MAG #1) ROPE CLIMBING STRUCTURE. SLIDE ON GRADE.



(MAG #2) WATER BUBBLER SPRAY PARK



(MAG #3) WATER BUBBLER SPRAY PARK



(MAG #4) SAND TABLE

NOTES:
1) COLORS OF PLAY SURFACE SHOULD MATCH THE FOUR EXISTING COLORS OF THE ARTFUL SHADE STRUCTURE
2) CONTRACTOR IS RESPONSIBLE FOR FINAL DESIGN OF ALL LIFE COMPONENTS
3) CONTRACTOR TO VERIFY ALL WORK IS IN COMPLIANCE WITH ALL GOVERNING OR APPLICABLE CODES AND ORDINANCES INCLUDING, BUT NOT LIMITED TO THE FOLLOWING: DC, ASHRAE, DISTRICT OF COLUMBIA CODES, CHESAPEAKE BAY WATERSHED RESTORATION, ETC.
4) ALL EX. TREES ARE TO REMAIN, EX. TREES ARE SHOWN AT APPROPRIATE LOCATION. CONTRACTOR TO ENSURE NECESSARY TREE PROTECTION MEASURES AS PER D.C. STANDARDS.



MACOMB WASHINGTON, D.C.

Prepared for DPR by STUDIO39

THIS DOCUMENT IS FOR ILLUSTRATIVE PURPOSES ONLY AND MAY NOT REFLECT ACTUAL QUANTITIES, DIMENSIONS, MATERIAL, OR CONDITIONS.

Move • Grow • Be Green with DPR
DEPARTMENT OF PARKS AND RECREATION

1250 U Street, NW, Washington, DC 20009 • Phone: (202) 673-7647 • Fax: (202) 673-2087 • Web: dpr.dc.gov